

# LIVING ON CAMPUS AT ST. CLOUD STATE

## WHAT TO BRING CHECKLIST



### Clothing & Accessories

- \_\_\_ Husky Apparel/Gear
- \_\_\_ Closet Organizer
- \_\_\_ Coat/Hat/Scarf/Gloves
- \_\_\_ Daily Wear, Shoes, Boots
- \_\_\_ Sleepwear & Slippers
- \_\_\_ Sunglasses/Sunscreen
- \_\_\_ Bathing Suit
- \_\_\_ Umbrella



### Cookware Accessories

- \_\_\_ Can Opener
- \_\_\_ Chip Clips
- \_\_\_ Dish Soap
- \_\_\_ Dish-Scrub Brush/Cloth
- \_\_\_ Eating Utensils
- \_\_\_ Food Storage Containers
- \_\_\_ Canned Soup/Ramen
- \_\_\_ Instant Coffee/Tea/Etc.
- \_\_\_ Cereal/Granola/Etc.
- \_\_\_ Microwave Popcorn
- \_\_\_ Bottled Water/Juice
- \_\_\_ Plate/Cups/Bowls



### Desk Supplies

- \_\_\_ Assignment Planner
- \_\_\_ Backpack/Book Bag
- \_\_\_ Calculator
- \_\_\_ Calendar
- \_\_\_ Desk Organizer
- \_\_\_ Folders
- \_\_\_ Notebooks/Loose Paper
- \_\_\_ Paper Clips
- \_\_\_ Pens/Pencils/Highlighter
- \_\_\_ Post-Its/Sticky-Tabs
- \_\_\_ Push Pins
- \_\_\_ Scissors/Ruler/Glue
- \_\_\_ Tape/White-Out



### Laundry Essentials

- \_\_\_ Laundry Bag/Basket
- \_\_\_ Detergent Pods/Softener
- \_\_\_ Lint Roller
- \_\_\_ Tide-To-Go Stick



### Misc.

- \_\_\_ Air Freshener
- \_\_\_ Area Rug/Carpet
- \_\_\_ Broom/Swiffer
- \_\_\_ Fan (Pedestal/Oscillating)
- \_\_\_ Garbage Can Liners/Bags
- \_\_\_ Microwave
- \_\_\_ Mini-Fridge of <4.3 Cubic ft
- \_\_\_ Plant(s)
- \_\_\_ Wall Décor/Posters/Etc.  
(use only removable hangers)



### Bedding

- \_\_\_ 2-3 Pillows
- \_\_\_ 2 Sets of Twin XL Sheets



### Personal Care

- \_\_\_ Band-Aids/Ointment
- \_\_\_ Bath Robe
- \_\_\_ 2 Bathroom Towels
- \_\_\_ Box of Tissues
- \_\_\_ Contact Solution
- \_\_\_ Cough Drops
- \_\_\_ Deodorant
- \_\_\_ Ear Plugs
- \_\_\_ Lotion
- \_\_\_ Nail Clipper
- \_\_\_ Shampoo/Conditioner
- \_\_\_ Hair Dryer/Comb/Brush
- \_\_\_ Shower Shoes
- \_\_\_ Toothbrush/Toothpaste
- \_\_\_ Washcloth
- \_\_\_ Prescriptions
- \_\_\_ Health Insurance Card
- \_\_\_ Shower Caddy



### In case of illness

- \_\_\_ Electrolytes (Pedialyte)
- \_\_\_ Water and/or water bottle
- \_\_\_ Masks (reusable/washable)
- \_\_\_ Cleaning supplies- In room use only
- \_\_\_ Hand sanitizer (above 60% alcohol)
- \_\_\_ Hand soap
- \_\_\_ Digital Thermometer
- \_\_\_ Kleenex



### Technology

- \_\_\_ Computer
- \_\_\_ SmartTV or TV
- \_\_\_ Headphones
- \_\_\_ Ethernet Cable
- \_\_\_ Extension Cord
- \_\_\_ Phone Charger
- \_\_\_ Surge Protector
- \_\_\_ USB Flash Drive(s)



### Recommended Items

*Items below are available for rental in your community.*

- \_\_\_ Pots/Pans/Cookie sheets
- \_\_\_ Cutting Board
- \_\_\_ Pasta Strainer
- \_\_\_ Oven Mitt(s)
- \_\_\_ Cooking Utensils  
Spatulas, large cooking spoon, pasta spoon



### Prohibited Items

- \_\_\_ Candles/Incense
- \_\_\_ Wireless routers (if wifi is enabled)
- \_\_\_ Hot Plate
- \_\_\_ Open-Flame Devices
- \_\_\_ Oversized Speakers
- \_\_\_ Alcohol or Alcoholic Beverage Ctr.
- \_\_\_ Firearms, Weapons,  
Fireworks or Explosives
- \_\_\_ Hover boards



### Refrigerator

Students may have a refrigerator, not to exceed 4.3 cubic feet; refrigerators and microwaves can be rented.



### Storage

Due to limited space, the university does not provide storage; please plan accordingly.



### University Furniture

These items may not be moved between rooms or removed from halls or lounges without Residential Life consent: beds, chairs, window coverings, closets, or related components.



## Room Condition Report (RCR)

Residents review an RCR when they move into their room. The RCR is then used to evaluate the condition of the room at check-out. Students are then responsible for any additional damages to their space.



### Sending Mail to Your Student

Student's Name  
Street Address (see below)  
Hall Name  
St. Cloud, MN 56301

**Stearns Hall**  
410 3rd Ave S. Room #

**Shoemaker Hall**  
915 1st Ave S. Room #

**Stateview Apartments North**  
410 4th Ave S. Apartment #

**Stateview Apartments South**  
422 4th Ave S. Apartment #

### ADDRESSES:

**Case - Hill Hall**  
550 3rd Ave S. Room #

**Mitchell Hall**  
566 1st Ave S. Room #

**Lawrence Hall**  
650 1st Ave S, Room #

### How to Register your Media Devices

In order to connect your media device(s) to the network, you will need to register on the 'scsugadgets' network with what is known as your MAC Address.

[Article - How to Register your device... \(stcloudstate.edu\)](#)

To learn more, go to [stcloudstate.edu](http://stcloudstate.edu) and search for "scsu gadgets"

### Join the Husky Family Hub!

When you join the Husky Family Hub, you'll find all the information you need, in one convenient location. You'll find campus news, upcoming events & deadlines, & posts geared toward your interests.

[www.stcloudstate.edu/parents/](http://www.stcloudstate.edu/parents/)

**Stearns Hall**

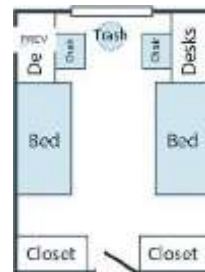

**Mitchell Hall**

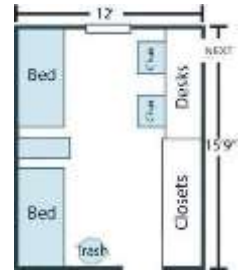

**Case-Hill Hall**



**Lawrence Hall**

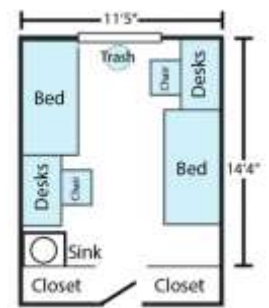

**Shoemaker Hall**

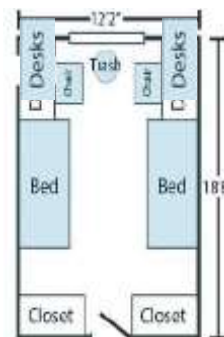

**Stateview Apts.**

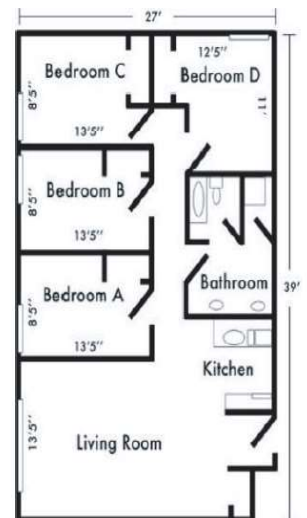

\*\*Shaded areas are moveable.



DEPARTMENT OF  
RESIDENTIAL LIFE  
ST. CLOUD STATE UNIVERSITY

(320) 308-2166 | [reslife@stcloudstate.edu](mailto:reslife@stcloudstate.edu)  
[www.stcloudstate.edu/reslife](http://www.stcloudstate.edu/reslife)



MINNESOTA STATE

St. Cloud State University,  
A member of Minnesota State