

# VIDEO EDITING WITH iMOVIE

## For Mac Use Only

### Procedures for Canon Vixia HF R100

#### Steps to find Mac computer:



1. The only supported video editing software in SCSU's General Access Computer Labs is iMovie on a Mac computer.
2. Access <http://goo.gl/gAKjYQ> to find a Mac computer nearby.

#### Steps to connect camcorder:

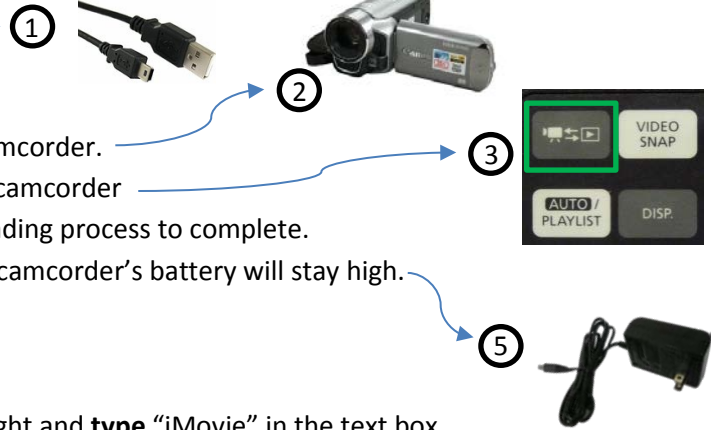
1. **Plug in USB cable** from camcorder to Mac.
2. **Open the LCD screen** and **press the power button** on the camcorder.
3. Once the camcorder is on, **press the connect button** on the camcorder
4. On the LCD screen, **select Computer/Printer** and wait for loading process to complete.
5. **Plug in power supply cable** from camcorder to wall plug, so camcorder's battery will stay high.



#### Steps to start iMovie and import video:

1. On Mac, **click on** the spotlight icon  located at the top right and **type** "iMovie" in the text box.
2. **Click on** the iMovie  to launch the program.
3. On the **top middle of iMovie** screen, **click on Media**.
4. On the **top left of iMovie** screen, **click on import** ↓ > camera > [select video(s)] > **click import** located at the bottom right.
5. On the **top middle of iMovie** screen, **click on theater**.
6. **Click on either New Movie or New Trailer**.
7. User may now edit the video in **iMovie**.

#### Steps to export video:

1. When finished with the editing, user may export the movie to FlashDrive, DataHD, social media and more.
2. On the **top left of iMovie** screen, click on share  > [select location] > Next > Save (type a movie name)
  - To save movie to FlashDrive, select location as "File" and choose the [name of the FlashDrive]. **(Recommended)**
  - To save movie to DataHD, select location as "File" and choose "DataHD". Movie saved to DataHD will remain saved on that particular Mac computer. **(Not Recommended: see note below)**
  - To save movie to Facebook, select location as "Facebook".

**Note: By default, files are saved locally on the "DataHD" partition, so user must use the same Mac for editing. It is recommended that user defines a new saving location such as a physical FlashDrive. Saving in any other location beside "DataHD" or "FlashDrive" will be erased when you log off!**

**For help: Please go to HuskyTech or call (320) 308-7000.**